

X\$D ULTRA® 841

TEFC- Extra Severe Duty

Dimensions

Dimensions refer to drawing on following page.

Cast Iron Construction/Frames 140-449, Type KS, 3-Phase/Dimensions – For Estimating Only.

Frame	Approx. Net Weight in lbs	Dimensions in Inches																				
		Shaft					Mounting ¹⁸															
		Key		Length	N-W	U ⁽¹⁾	V	E	H	BA	BS	2F	2XF	A	B	C	D ⁽³⁾	G	J	K	L	O
Width	Depth																					
143T	43	0.187	0.187	1.380	2.25	0.8748	2.12	2.75	0.39	2.25	2.25	5.00	4.00	6.88	5.88	13.42	3.50	0.40	1.39	2.32	6.42	7.25
145T	50	0.187	0.187	1.380	2.25	0.8748	2.12	2.75	0.39	2.25	2.25	5.00	4.00	6.88	5.88	13.42	3.50	0.40	1.39	2.32	6.42	7.25
182T	76	0.250	0.250	1.750	2.75	1.1250	2.50	3.75	0.46	2.75	2.75	5.50	4.50	8.68	6.64	15.91	4.50	0.46	1.54	2.58	7.66	9.25
184T	101	0.250	0.250	1.750	2.75	1.1250	2.50	3.75	0.46	2.75	2.75	5.50	4.50	8.68	6.64	15.91	4.50	0.46	1.54	2.58	7.66	9.25
213T	200	0.312	0.312	2.380	3.38	1.3750	3.12	4.25	0.46	3.50	3.50	7.00	5.50	9.60	8.00	20.15	5.25	0.57	1.47	3.12	9.77	10.43
215T	220	0.312	0.312	2.380	3.38	1.3750	3.12	4.25	0.46	3.50	3.50	7.00	5.50	9.60	8.00	20.15	5.25	0.57	1.47	3.12	9.77	10.43
254T	315	0.375	0.375	2.380	4.00	1.6250	3.76	5.00	0.58	4.25	5.00	10.00	8.25	11.20	11.30	25.29	6.25	0.65	1.52	3.93	12.34	12.50
256T	350	0.375	0.375	2.880	4.00	1.6250	3.76	5.00	0.58	4.25	5.00	10.00	8.25	11.20	11.30	25.29	6.25	0.65	1.52	3.93	12.34	12.50
284TS	460	0.375	0.375	1.880	3.25	1.6250	3.00	5.50	0.58	4.76	5.50	11.00	9.50	12.40	12.80	27.20	7.00	0.76	1.75	4.12	13.70	13.88
284T	460	0.500	0.500	3.250	4.62	1.8750	4.38	5.50	0.58	4.76	5.50	11.00	9.50	12.40	12.80	28.58	7.00	0.76	1.75	4.12	13.70	13.88
286TS	510	0.500	0.500	1.880	3.25	1.6250	3.00	5.50	0.58	4.76	5.50	11.00	9.50	12.40	12.80	27.20	7.00	0.76	1.75	4.12	13.70	13.88
286T	510	0.500	0.500	3.250	4.62	1.8750	4.38	5.50	0.58	4.76	5.50	11.00	9.50	12.40	12.80	28.58	7.00	0.76	1.75	4.12	13.70	13.88
324TS	664	0.500	0.500	2.000	3.75	1.8750	3.50	6.25	0.67	5.25	6.00	12.00	10.50	14.40	13.80	29.04	8.00	0.99	2.01	3.62	15.54	17.07
324T	664	0.500	0.500	3.880	5.25	2.1250	5.00	6.25	0.67	5.25	6.00	12.00	10.50	14.40	13.80	30.54	8.00	0.99	2.01	3.62	15.54	17.07
326TS	800	0.500	0.500	2.000	3.75	1.8750	3.50	6.25	0.67	5.25	6.00	12.00	10.50	14.40	13.80	30.54	8.00	0.99	2.01	3.62	15.54	17.07
326T	800	0.500	0.500	3.880	5.25	2.1250	5.00	6.25	0.67	5.25	6.00	12.00	10.50	14.40	13.80	32.04	8.00	0.99	2.01	3.62	15.54	17.07
364TS	1122	0.500	0.500	2.000	3.75	1.8750	3.50	7.00	0.69	5.88	6.13	12.25	11.25	16.00	14.40	32.76	9.00	1.09	2.26	3.40	17.00	19.02
364T	1122	0.625	0.625	4.250	5.88	2.3750	5.64	7.00	0.69	5.88	6.13	12.25	11.25	16.00	14.40	43.89	9.00	1.09	2.26	3.40	17.00	19.02
365TS	1155	0.500	0.500	2.000	3.75	1.8750	3.50	7.00	0.69	5.88	6.13	12.25	11.25	16.00	14.40	32.76	9.00	1.09	2.26	3.40	17.00	19.02
365T	1155	0.625	0.625	4.250	5.88	2.3750	5.64	7.00	0.69	5.88	6.13	12.25	11.25	16.00	14.40	43.89	9.00	1.09	2.26	3.40	17.00	19.02
404TS	1580	0.500	0.500	2.750	4.25	2.1250	4.00	8.00	0.81	6.62	6.88	13.75	12.25	18.00	16.00	36.76	10.00	1.29	2.64	4.00	19.02	21.18
404T	1580	0.750	0.750	5.625	7.25	2.8750	7.00	8.00	0.81	6.62	6.88	13.75	12.25	18.00	16.00	39.77	10.00	1.29	2.64	4.00	19.02	21.18
405TS	1600	0.500	0.500	2.750	4.25	2.1250	4.00	8.00	0.81	6.62	6.88	13.75	12.25	18.00	16.00	36.76	10.00	1.29	2.64	4.00	19.02	21.18
405T	1600	0.750	0.750	5.625	7.25	2.8750	7.00	8.00	0.81	6.62	6.88	13.75	12.25	18.00	16.00	39.77	10.00	1.29	2.64	4.00	19.02	21.18
444TS	2100	0.625	0.625	3.000	4.75	2.3750	4.50	9.00	0.81	7.50	8.25	16.50	14.50	20.00	18.80	41.87	11.00	1.49	2.64	4.97	21.37	23.94
444T	2100	0.875	0.875	6.875	8.50	3.3750	8.25	9.00	0.81	7.50	8.25	16.50	14.50	20.00	18.80	45.62	11.00	1.49	2.64	4.97	21.37	23.94
445TS	2260	0.625	0.625	3.000	4.75	2.3750	4.50	9.00	0.81	7.50	8.25	16.50	14.50	20.00	18.80	41.87	11.00	1.49	2.64	4.97	21.37	23.94
445T	2260	0.875	0.875	6.875	8.50	3.3750	8.25	9.00	0.81	7.50	8.25	16.50	14.50	20.00	18.80	45.62	11.00	1.49	2.64	4.97	21.37	23.94
447TS	2610	0.625	0.625	3.000	4.75	2.3750	4.50	9.00	0.81	7.50	12.50	25.00	20.00	20.00	27.30	50.37	11.00	1.49	2.64	8.81	25.62	23.94
447T	2610	0.875	0.875	6.875	8.50	3.3750	8.25	9.00	0.81	7.50	12.50	25.00	20.00	20.00	27.30	54.12	11.00	1.49	2.64	8.81	25.62	23.94
449TS ⁽¹⁹⁾	3010	0.625	0.625	3.000	4.75	2.3750	4.50	9.00	0.81	7.50	12.50	25.00	20.00	20.00	27.30	50.37	11.00	1.49	2.64	8.81	25.62	23.94
449T	3010	0.875	0.875	6.875	8.50	3.3750	8.25	9.00	0.81	7.50	12.50	25.00	20.00	20.00	27.30	54.12	11.00	1.49	2.64	8.81	25.62	23.94

1. Shaft diameters 1 1/2 inches and smaller will come within the limits of +0.000 inch, -0.0005 inch diameters 1 5/8 inches and larger +0.000 inch, -0.001 inch.
3. Tolerance on "D" dimension for rigid base motors will be +0.000 inch, -0.060 inch. No tolerance has been est. for the "D" dimension of resilient mounted motors.
18. Motor feet have 2 holes per foot allowing NEMA F-1 or F-2 assembly while maintaining critical NEMA mounting dimensions.
19. Cast iron motors in 449 frame also have mounting holes meeting 447 frame dimensions.
Providing mounting conditions permit, conduit box may be turned so that entrance can be made upward, downward, or from either side. Weights shown are approximate shipping weights and should be used for estimating only.



X\$D ULTRA® 841

TEFC- Extra Severe Duty

Dimensions cont.

Frame dimensions on previous page.

Cast Iron Construction/Frames 140-449, Type KS, 3-Phase/Dimensions – For Estimating Only.

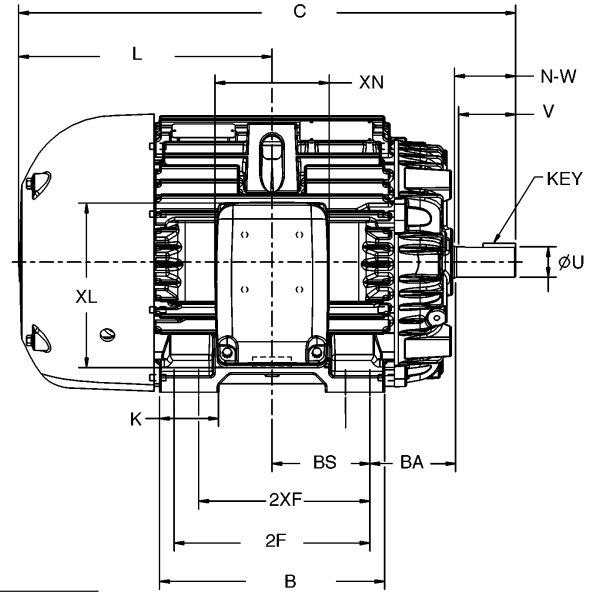
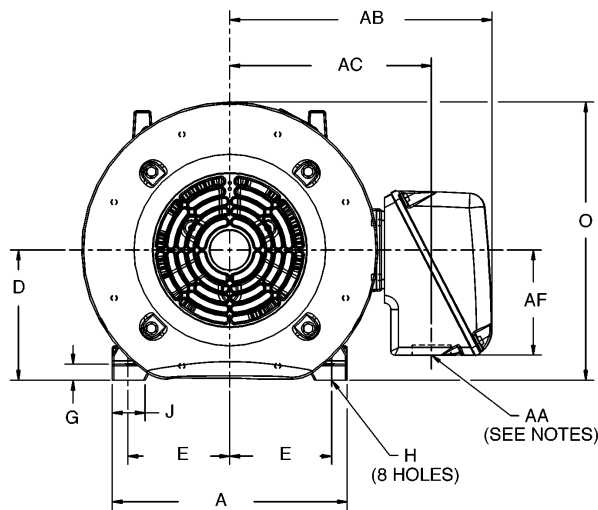

Conduit Box Dimensions

Frame	Nominal Hp	Approx. Vol.	Dimensions in Inches					
			AA*	AB	AC	AF	XL	XN
143-145	2	32	0.75	6.62	5.12	2.50	4.30	5.40
182-184	5	32	0.75	7.82	6.32	2.50	4.30	5.40
213-215	10	55	1.00	9.50	7.42	3.50	5.78	4.16
254-256	20	140	1.25	11.68	9.12	4.59	7.37	5.37
284-286	30	140	1.50	12.44	9.88	4.59	7.37	5.37
324-326	50	346	3.00	16.13	12.43	6.44	10.14	7.00
364-365	75	346	3.00	17.07	13.37	6.44	10.14	7.00
404-405	125	700	3.00	20.48	16.22	7.00	12.13	10.50
444-449	200	700	3.00	22.00	17.74	7.00	12.13	10.50
444-449	250-300	1500**	4.00	22.30	180.50	8.12	13.74	17.15

* A tapped NPT hole is provided for the conduit size listed in Column AA

** Fabricated steel

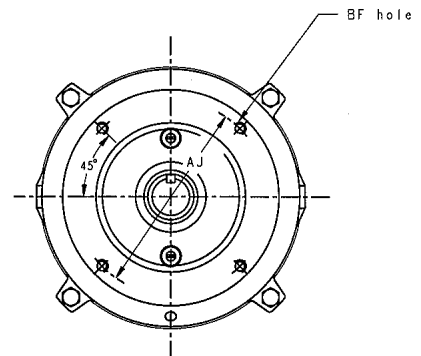

C-Face Dimensions

NEMA Frame	All Dimensions in inches						
	AH	AJ	AK	U	Key Width	Key Thickness	Key Length
143TC-145TC	2.12	5.88	4.50	0.875	0.19	0.19	1.38
182TC-184TC	2.62	7.25	8.50	1.125	0.25	0.25	1.75
213TC-215TC	3.12	7.25	8.50	1.375	0.31	0.31	2.38
254TC-256TC	3.75	7.25	8.50	1.625	0.38	0.38	2.88
284TC-286TC	4.38	9.00	10.50	1.875	0.50	0.50	3.25

